

## S-100 S-25

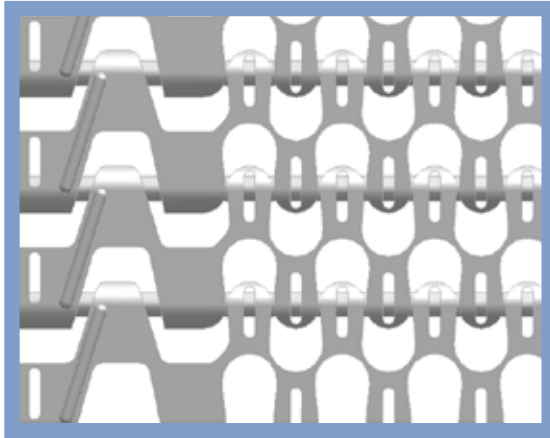

- ➔ Belt surface: Smooth.
- ➔ Open area: 52 %
- ➔ Strength: The ideal choice for medium weight
- ➔ Material: POM/PP
- ➔ Accessories: friction modules, hold-down.  
25, 50, 75 mm flights,  
25 mm side guards,
- ➔ Application: Spiral coolers, radius conveyors  
Construction: Side modules, centre modules.
- ➔ Width interval: Normal 20 mm. e.g. 209 mm, 229 mm.

### HUB SPECIFICATION

	Number of teeth		
	8Z	12Z	20Z
Round bore (mm)	20ø	20ø	
	25ø	25ø 30ø 40ø	25ø 30ø 40ø
Hexagon bore (mm)	24x24x24		
Square bore (mm)	25x25	25x25	25x25
		40x40	40x40

bore available in inch size

### BELT DATA

Materials	Rods	Max. belt pull kg/m of width	Belt weight kg/m <sup>2</sup>
Polyacetal (POM)	NYLON	110	7
	STEEL	150	12
Polypropylene (PP)	NYLON	90	4.5
	STEEL	100	9.7

### SPROCKET DATA

No. of teeth Z	A=Outside diameter (mm)	B=Pitch diameter (mm)	C=Inside diameter (mm)	Sprocket width (mm)
8	78	66	54	19
12	108	96	84	19
20	173	161	149	19

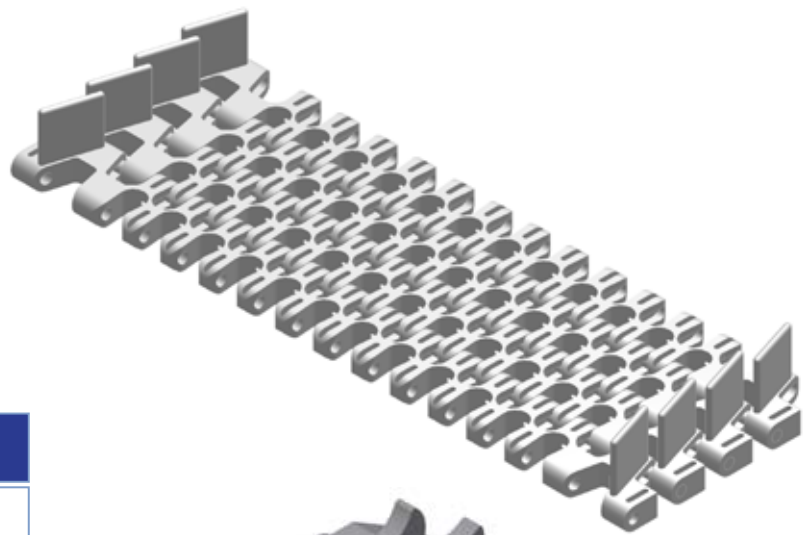
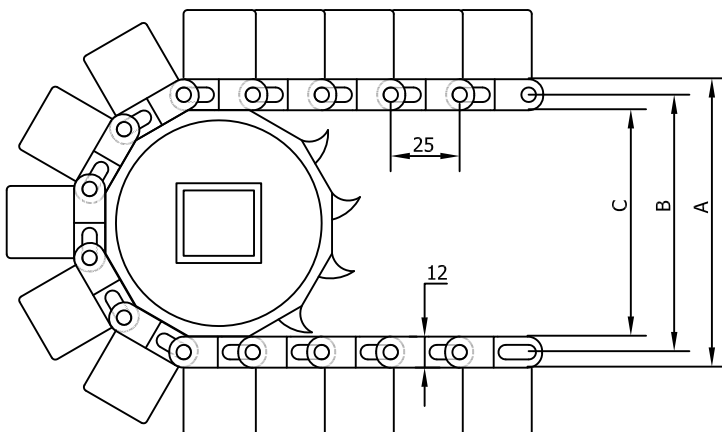

1:1